

Sept: 10, 1895. (School Ground.)

- A. Stake
- B. For corner
- C. In road grade
- D. For mound
- E. " "
- F. cedar Post
- G. " "
- H. " "

B. H. Woolstencroft

"I" Stone R.P. Tack in talpole S.E. 45°: A.P.

Tack in cor. fence post S.W. 44° F.A. March 1934

28  
29  
30  
31  
32  
33  
34  
35

SURVEY No. 23

Section 29 Town 105 Range 41

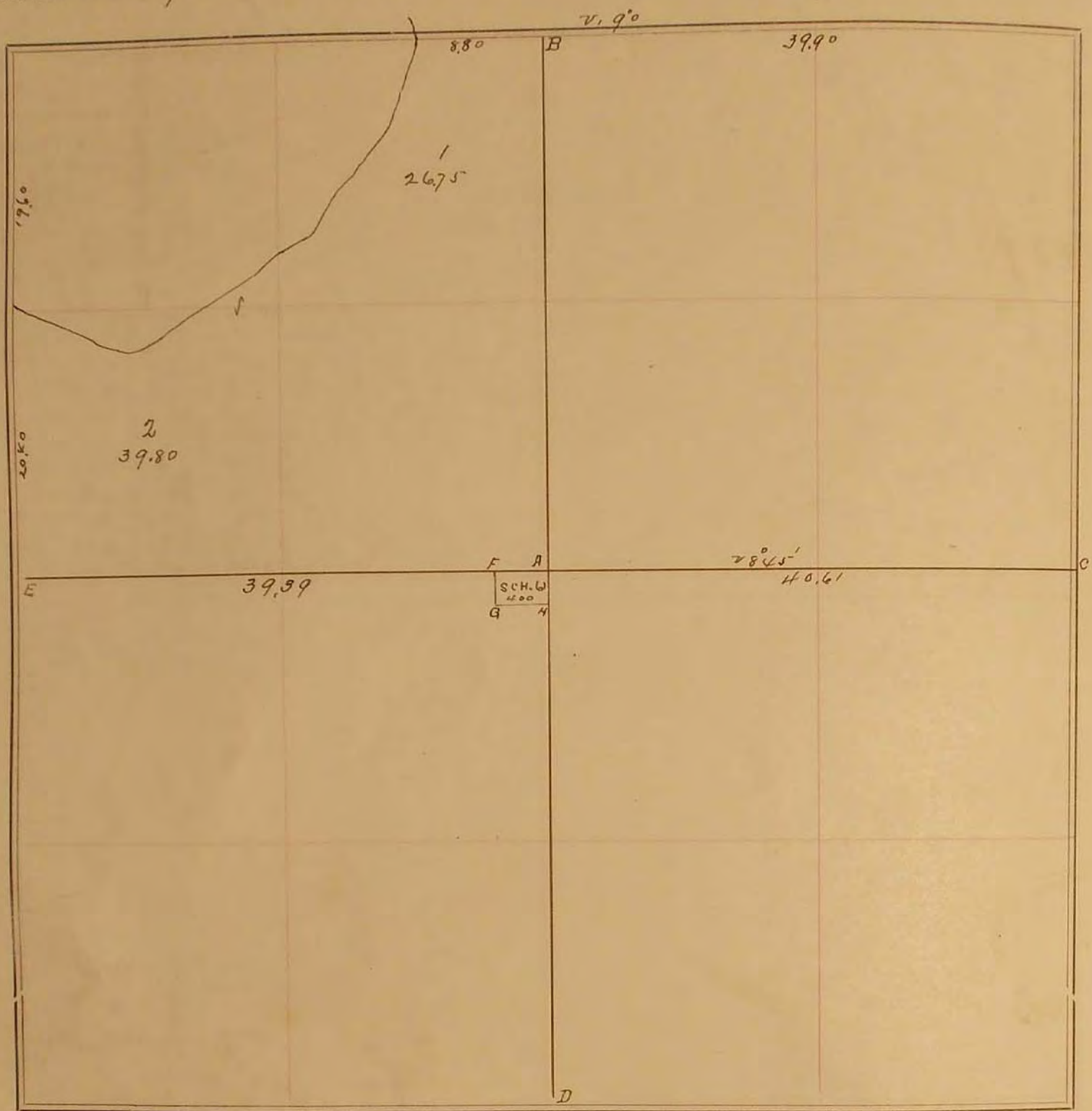

FIELD NOTES.

Surveyed Sept. 10, 1895

- A Stake
- B Gov. corner
- C In road grade
- D Gov mound
- E " "
- F cedar post
- G " "
- H " "

(B.N. Woodlawn)

"E" "stone" A.P. Tack intel. pole SE 45°: A.P. Tack in cor fence post  
 SW. 448' F.A. March.